

APPENDIX F

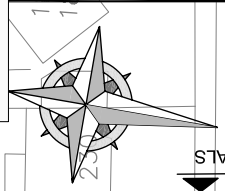
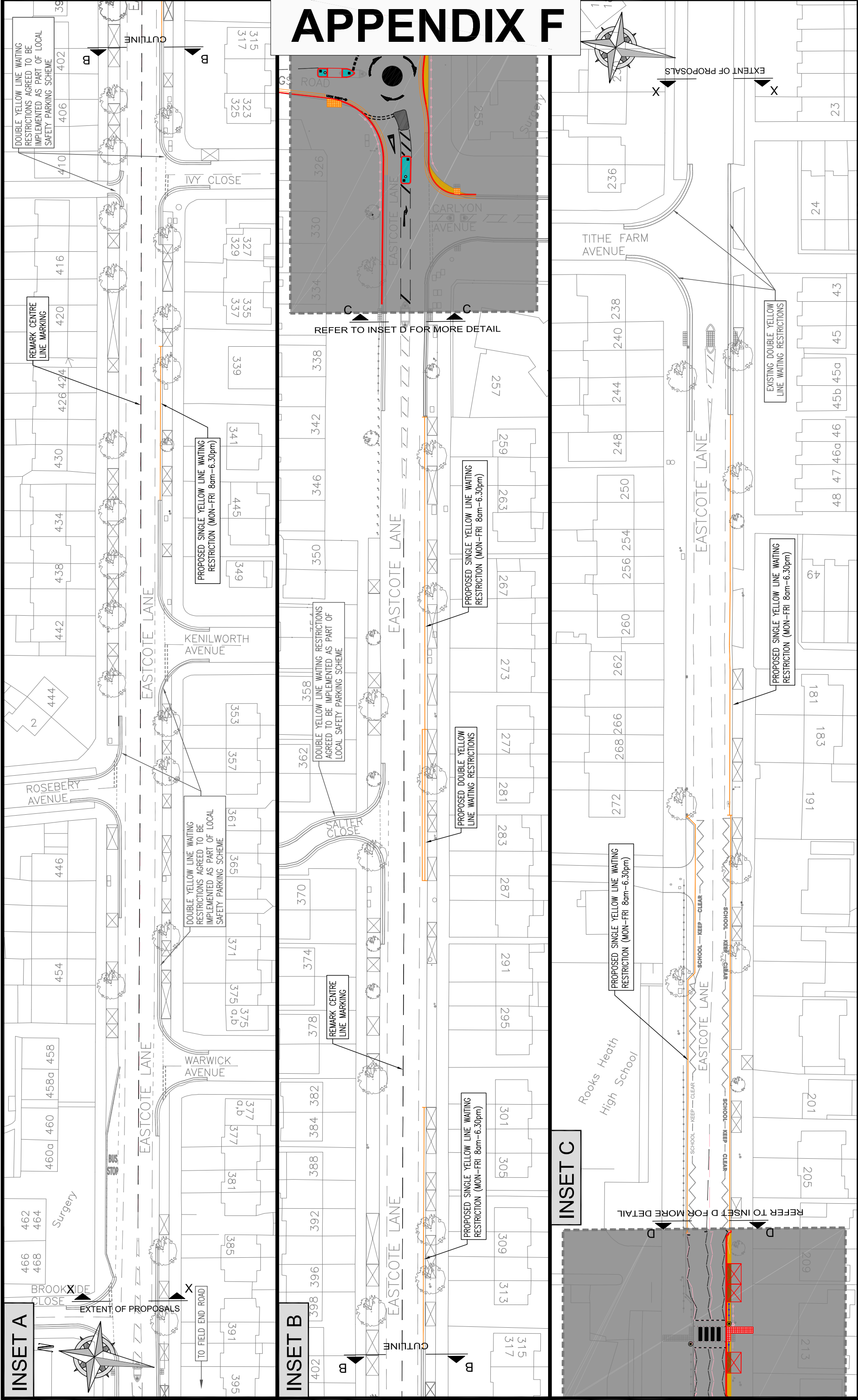

| REVISION | INITIALS | ISSUE AMENDMENT | TP 16.10.13 | TP 16.10.13 | DESIGNED BY | CHECKED BY | APPROVED BY |
|----------|----------|-----------------|-------------|-------------|-------------|------------|-------------|
| | | | AND DATE | AND DATE | AND DATE | AND DATE | AND DATE |
| | | | | | | | |

| | |
|--------------------|--|
| CLIENT | LONDON BOROUGH OF HARROW |
| PROJECT | TPR0139 : BUS PRIORITY SCHEME: EASTCOTE LANE |
| DRAWING TITLE | OUTLINE DESIGN FOR PUBLIC CONSULTATION |
| SHEET | 1 OF 2 |
| ISSUING OFFICE | HARROW |
| DRAWING NUMBER | TDWG000601 |
| ISSUE | 0208 424 7534 |
| SCALE (AT A2 SIZE) | SEE SCALE BAR |
| REVISION | A |

LONDON

EXISTING DOUBLE YELLOW LINE WAITING RESTRICTIONS
 EXISTING SINGLE YELLOW LINE WAITING RESTRICTIONS
 EXISTING TREE
 EXISTING VEHICLE CROSSOVER

PROPOSED DOUBLE YELLOW LINE WAITING RESTRICTIONS
 PROPOSED SINGLE YELLOW LINE WAITING RESTRICTIONS (SEE PLAN ABOVE FOR TIME DETAIL)
 PROPOSED NEW KERB LINE
 EXISTING ROAD MARKINGS TO BE REMOVED
 AGREED DOUBLE YELLOW LINES AS PART OF LOCAL SAFETY PARKING PROGRAMME

KEY:

Reproduction from the Ordnance Survey Mapping with the permission of the Controller of Her Majesty's Stationery Office © Crown Copyright. Unauthorised reproduction infringes Crown Copyright and may lead to prosecution of civil proceedings. London Borough of Harrow 100016006.

